

NORTH ARM OF FRASER RIVER

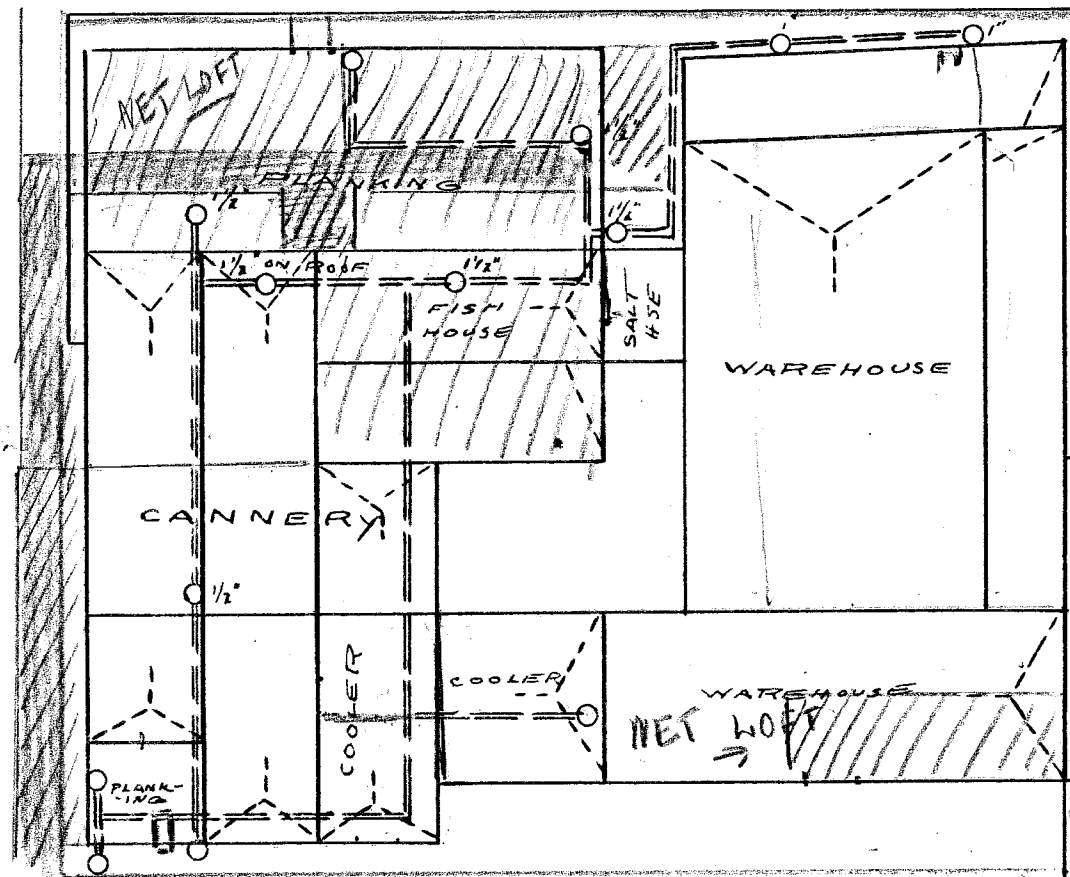

CITY MAIN 3" WOOD

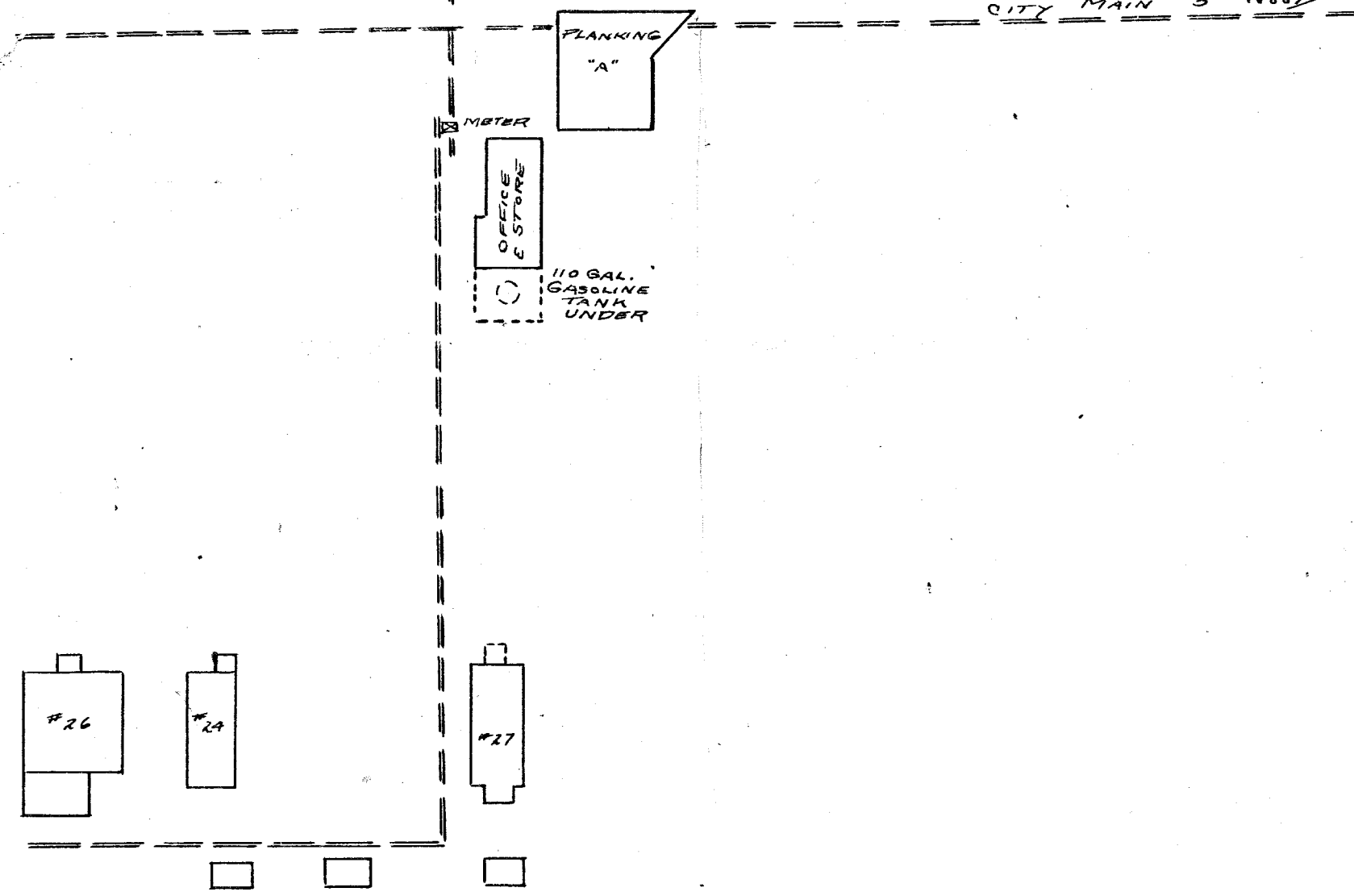

TERRA NOVA CANNERY  
BRITISH COLUMBIA PACKERS LTD.  
SCALE 1"=50' NORTH ARM OF FRASER RIVER B.C.  
GENERAL APPRAISAL CO. LTD.  
MAY 1946 VANCOUVER, B.C.

Terra Nova