



# City of Richmond

# Policy Manual

Page 1 of 2	Adopted by Council: March 19, 1990 Amended by Council: March 15, 1999 July 19, 2004	<b>POLICY 5437</b>
File Ref: 4430-00	SINGLE-FAMILY LOT SIZE POLICY IN QUARTER-SECTION 23-4-7	

**POLICY 5437:**

The following policy establishes lot sizes in Section 23-4-7, located between **Railway Avenue, Blundell Road, Francis Road and No. 1 Road:**

That properties within the area bounded by Blundell Road, Railway Avenue, Francis Road and No. 1 Road, in a portion of Section 23-4-7, but to exclude those properties fronting the north side of Francis Road between Railway Avenue and No. 1 Road and those properties fronting onto No. 1 Road, be permitted to subdivide in accordance with the provisions of Single-Family Housing District (R1/E) in Zoning and Development Bylaw 5300.

That this policy, as shown on the accompanying plan, be used to determine the disposition of future rezoning applications, for a period of not less than five years, unless amended according to the Zoning and Development Bylaw No. 5300.

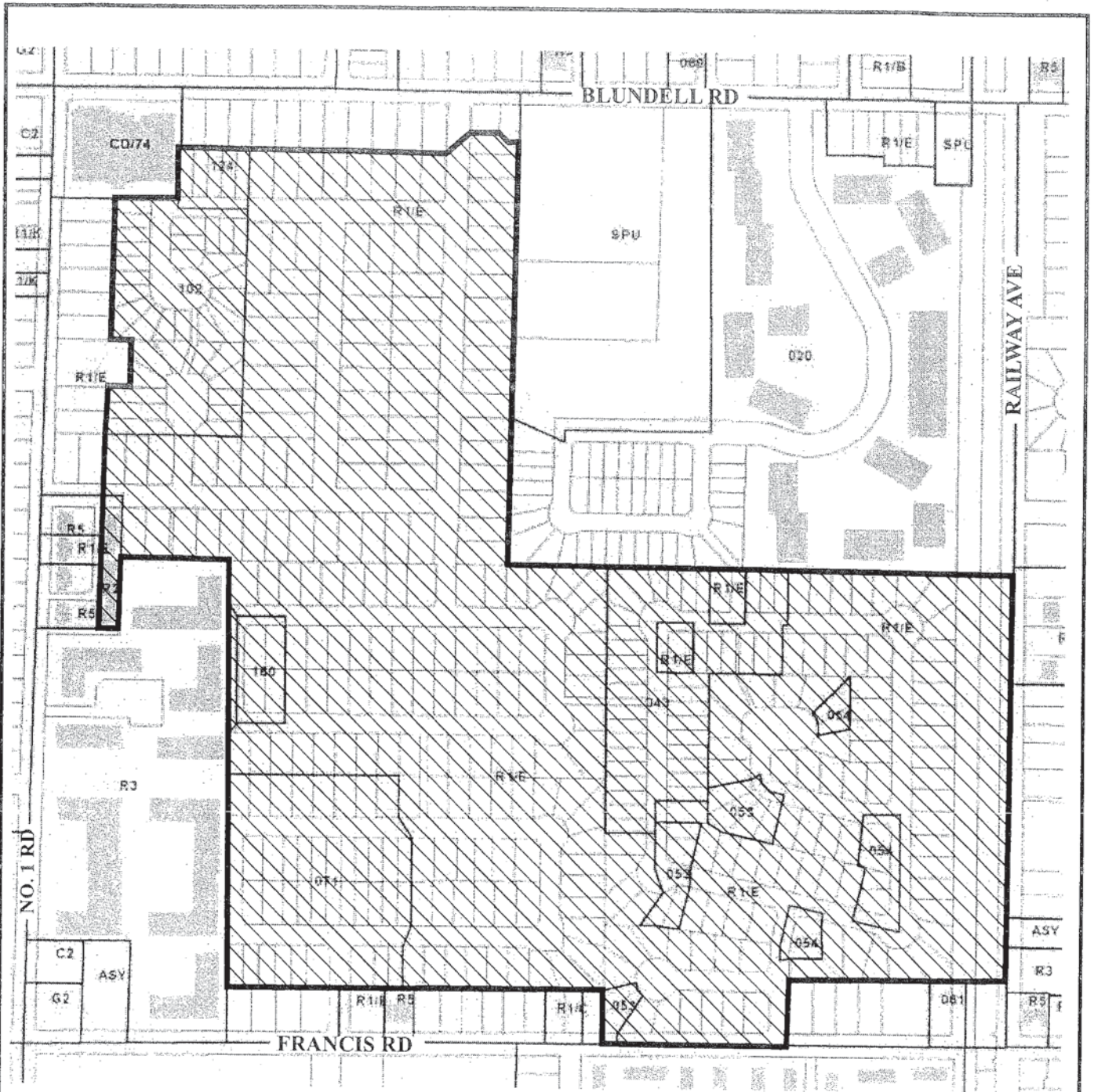

 Subdivision permitted as per R1/E



Policy 5437  
Section 23-4-7

Adopted Date: 03/19/90

Amended Date: 03/15/99  
07/19/04

Note: Dimensions are in METRES