



**Richmond Zoning and Development Bylaw 5300
Amendment Bylaw 7999 (RZ 05-315710)
3760 AND 3780 BROADWAY STREET**

The Council of the City of Richmond, in open meeting assembled, enacts as follows:

1. Richmond Zoning and Development Bylaw 5300 is amended by
 - i. Inserting the following subsection into the Single-Family Housing District (R1) Section 202.4 MINIMUM & MAXIMUM SETBACKS FROM PROPERTY LINES :

“.03A Notwithstanding the limitations imposed above, the minimum **rear yard** setback in the area bounded by Steveston Highway, No. 1 Road, Chatham Street, and 7th Avenue shall be as shown in Diagram 1, Section 202.4.05 PROVIDED THAT portions of the principal **building** greater than 5.5 m (18.045 ft.) in **building height** shall be setback a minimum of 6 m (19.685 ft.) from the **rear property line.**”
 - ii. Replacing Diagram 1 in Section 202.4.05 with the diagram shown is Schedule A.

2. The Zoning Map of the City of Richmond, which accompanies and forms part of Richmond Zoning and Development Bylaw 5300, is amended by repealing the existing zoning designation of the following area and by designating it “**Single-Family Housing District, Subdivision Area A (R1/A)**”.

P.I.D. 010-909-095

Lot 17 Block 22 Section 3 Block 3 North Range 7 West New Westminster District Plan 249

AND

P.I.D. 010-909-109

Lot 18 Block 22 Section 3 Block 3 North Range 7 West New Westminster District Plan 249

3. This Bylaw may be cited as “**Richmond Zoning and Development Bylaw 5300, Amendment Bylaw 7999**”.

FIRST READING

MAR 27 2006

A PUBLIC HEARING WAS HELD ON

APR 18 2006

SECOND READING

APR 18 2006

THIRD READING

APR 18 2006

OTHER REQUIREMENTS SATISFIED

JUN 07 2006

ADOPTED



MAYOR

CORPORATE OFFICER

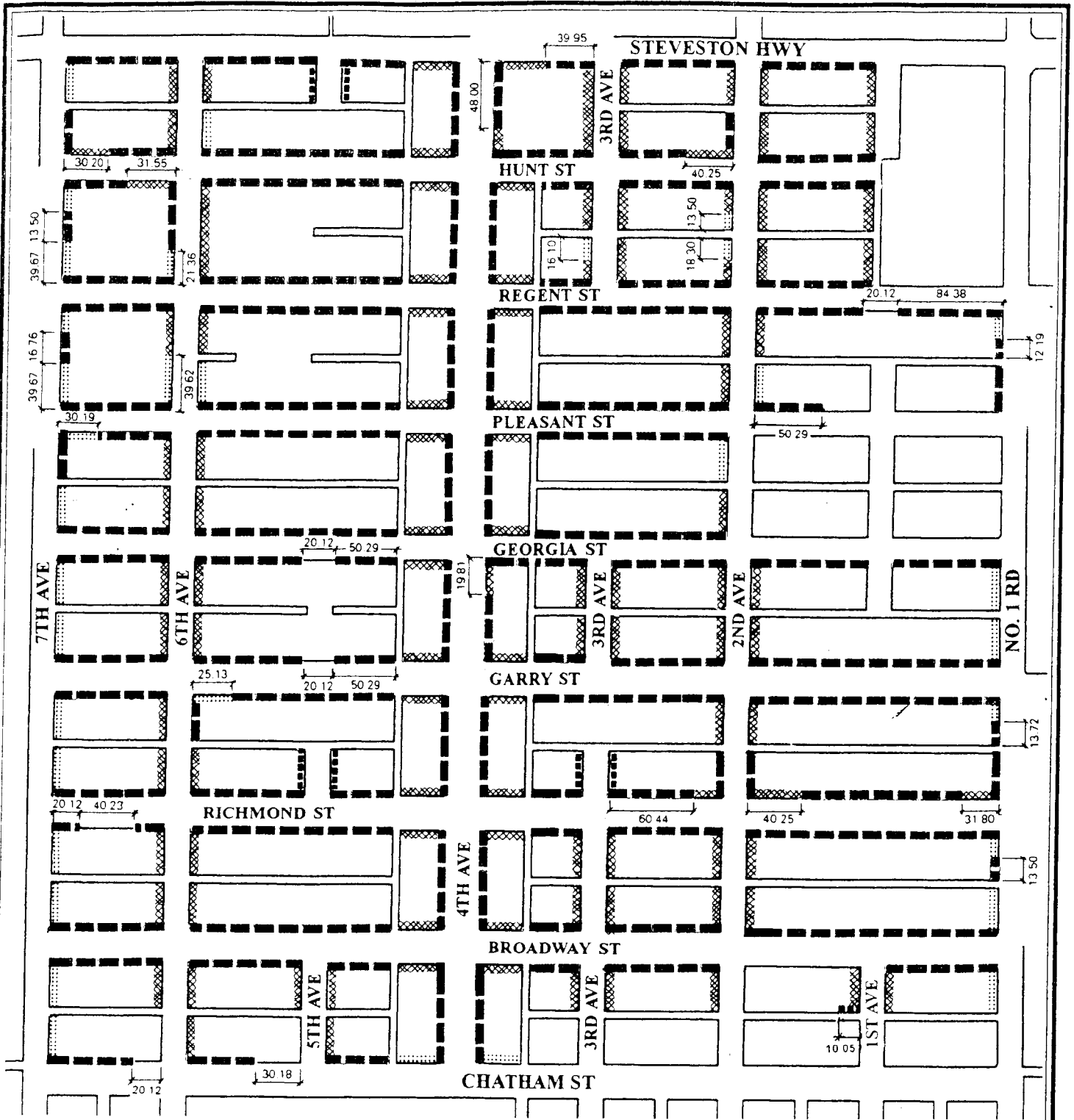

LEGEND

- 1.2 metre setback
- 1.8 metre setback
- 3.0 metre setback
- 6.0 metre setback

Note: All dimensions are in metres



**Bylaw 7999
Schedule A**

Date
02/28/06



City of Richmond

PROPOSED REZONING

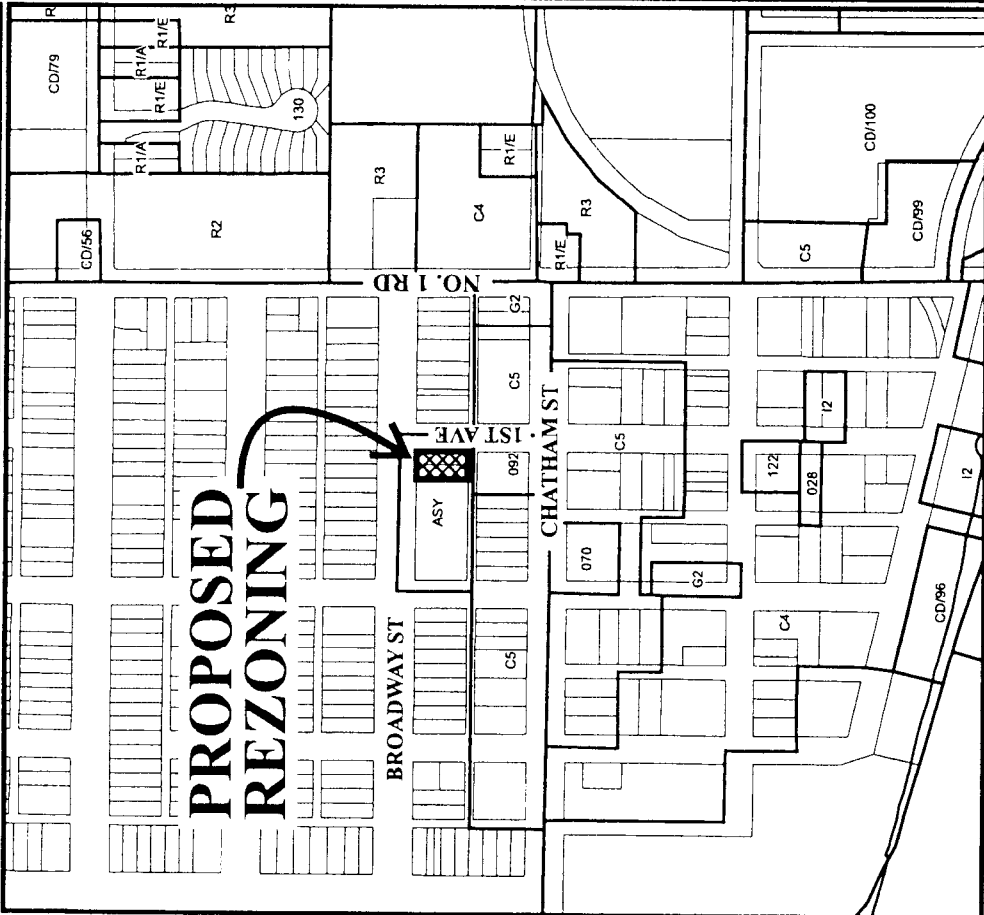

36.58	36.58	36.58	36.58	36.58	36.58	36.58	36.57	36.57	36.57
3771	3775	3791	3811	3815	3831	3835	3839	3851	12.35

BROADWAY ST

IST AVE

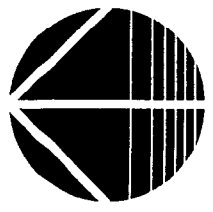
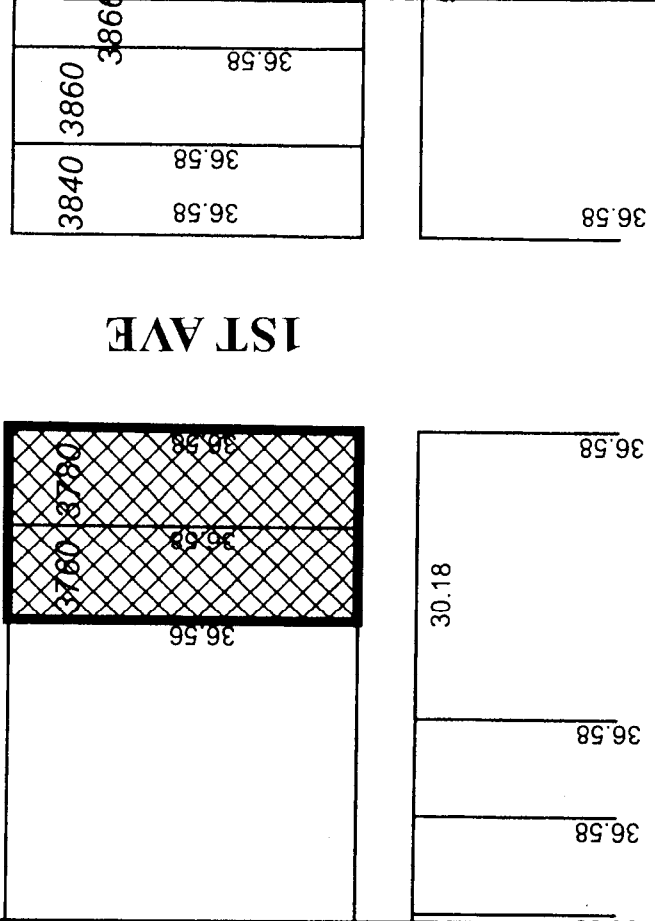

RZ 05-315710

Original Date: 11/08/05

Revision Date:

Note: Dimensions are in METRES