



Business & Financial Services Department
Telephone: 604-276-4097
Fax: 604-276-4162

May 12, 2010
File: 02-0775-50-3939/Vol 01

Dear Sir/ Madame,

Re: Addendum #1 3939Q – Hamilton Community Centre – Piling

The following change is hereby made a part of the Quote Documents as fully and wholly as if the same were fully set for the therein:

1. Drawing S1.1 Under the heading “Pile Foundations” refers to steel piles. Are there any steel piles in the RFQ?

This is a typo. There are no steel piles in this project.

2. Please clarify what you are referring to by. “pile metal and connection” in Specification 02350 1.8.1.4

If there is any steel head or shoe or any metal & connection required to install timber pile, shop drawings signed and sealed by P.Eng. registered in BC for those elements must be submitted to RJC and Levelton for review.

3. Who is responsible for providing the “Engineer” and “Geotechnical Engineer” referred to in Specification 02350?

Contractor is to provide engineering from surface prep to installation of piles. Levelton (hired by owner) will provide geotechnical services to monitor installation of piles.

4. If the City provides the engineers mentioned above, then would they not provide the letter referred to in section 1.8.4?

The Contractor is to provide engineering for pile installation. The engineer hired by the Contractor will submit shop drawings for any metal required for installation of pile to be approved by RJC.

5. I have not found the “shop drawings” referred to in specification 02350 3.4.8

Shop drawing are from the Contractor’s Engineer as required.

6. Site plan is as shown in SK-000, May 2, 2010. Contractor will be required to access the site from Gilley Road by use of the construction gravel road and work within the construction fence line as shown. Please see attached drawing "Site Plan Construction Hoarding Plan".

Yours truly,

A handwritten signature in black ink, appearing to read "S Dosanjh". The signature is fluid and cursive, with a large initial "S" and a stylized "D".

S Dosanjh
Buyer II - Contracting Specialist
City of Richmond

JOB TITLE
**HAMILTON COMMUNITY CENTRE
 EXPANSION PROJECT**

SHEET TITLE
**SITE PLAN
 CONSTRUCTION HOARDING
 PLAN**

Drawn DP
 Checked DC
 Job No. 0942

Date MAY 02, 10
 Scale N.T.S.
 Ref.

SK-000
 Revision: 00

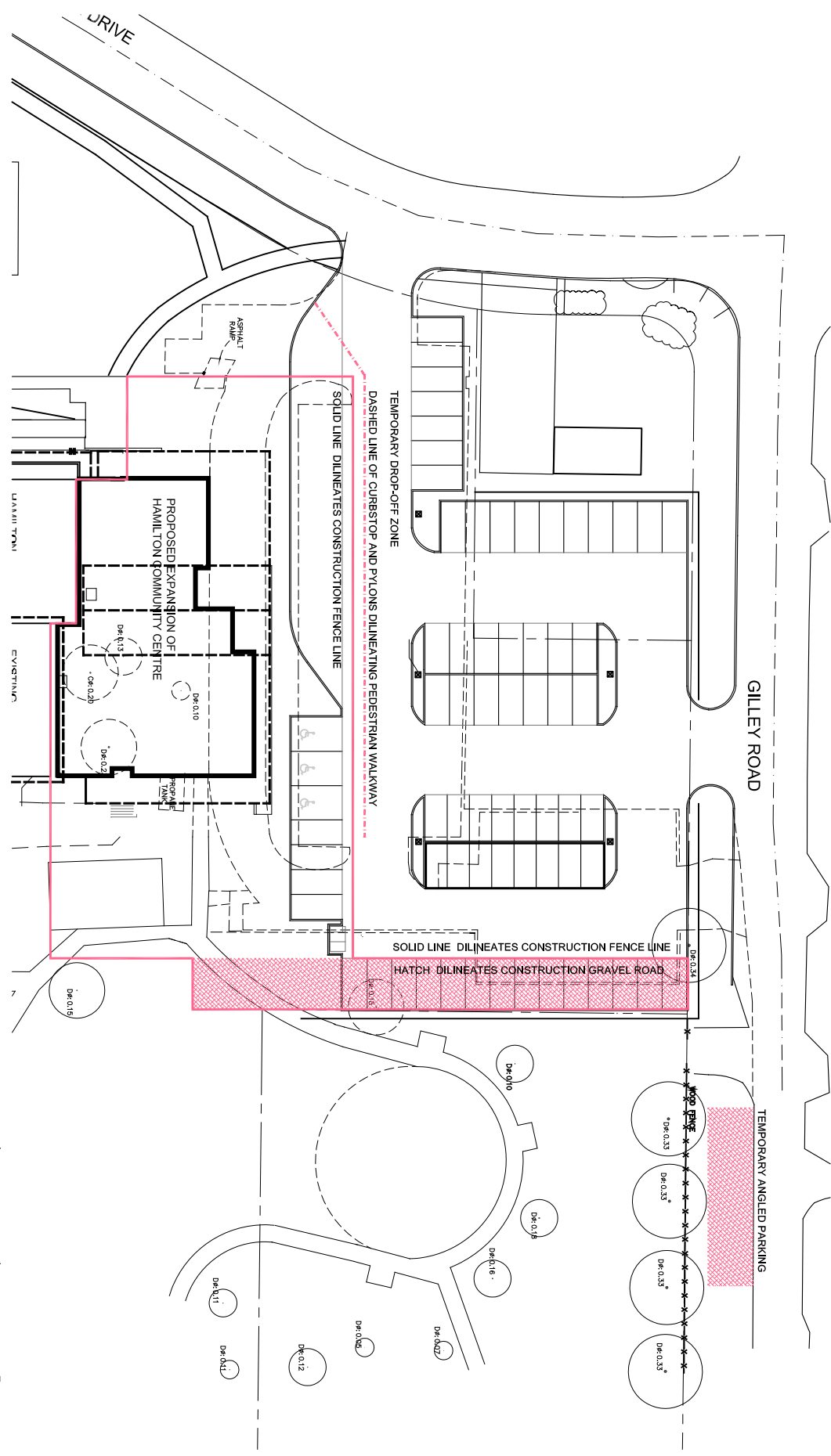

Hughes Condon Martier Architects
 Suite 300 - 1508 West 2nd Avenue
 Vancouver BC V6J 1H2 Canada
T 604.732.6620
F 604.732.6695
W hcm.ca

